

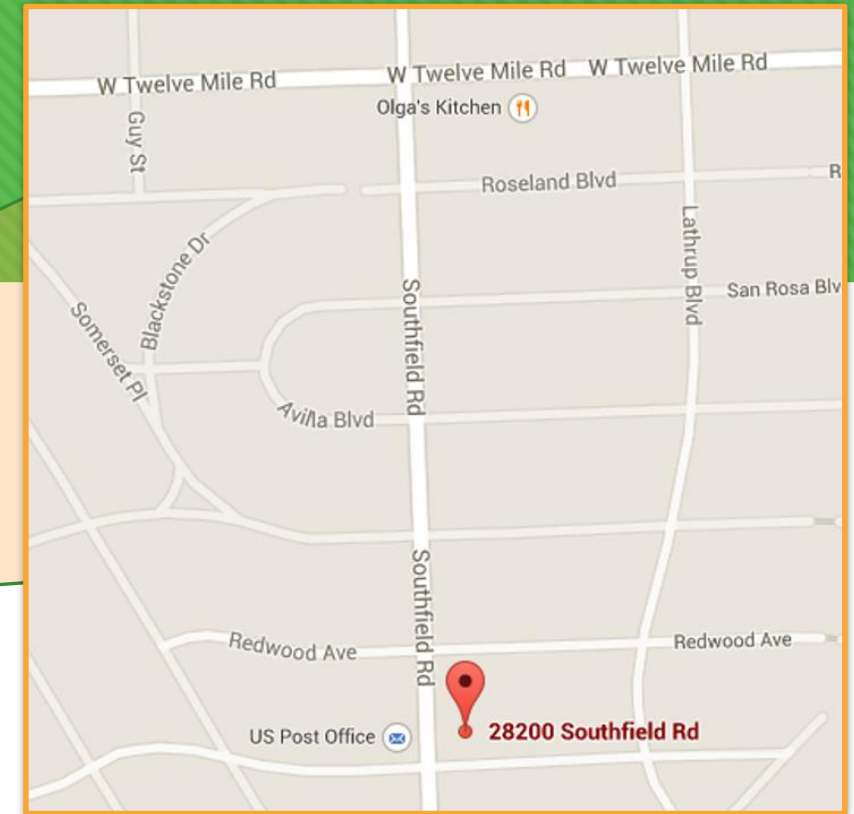

# LATHRUP VILLAGE REDEVELOPMENT READY

**28200 Southfield Road** – PROPERTY INFORMATION PACKAGE

# SITE LOCATION

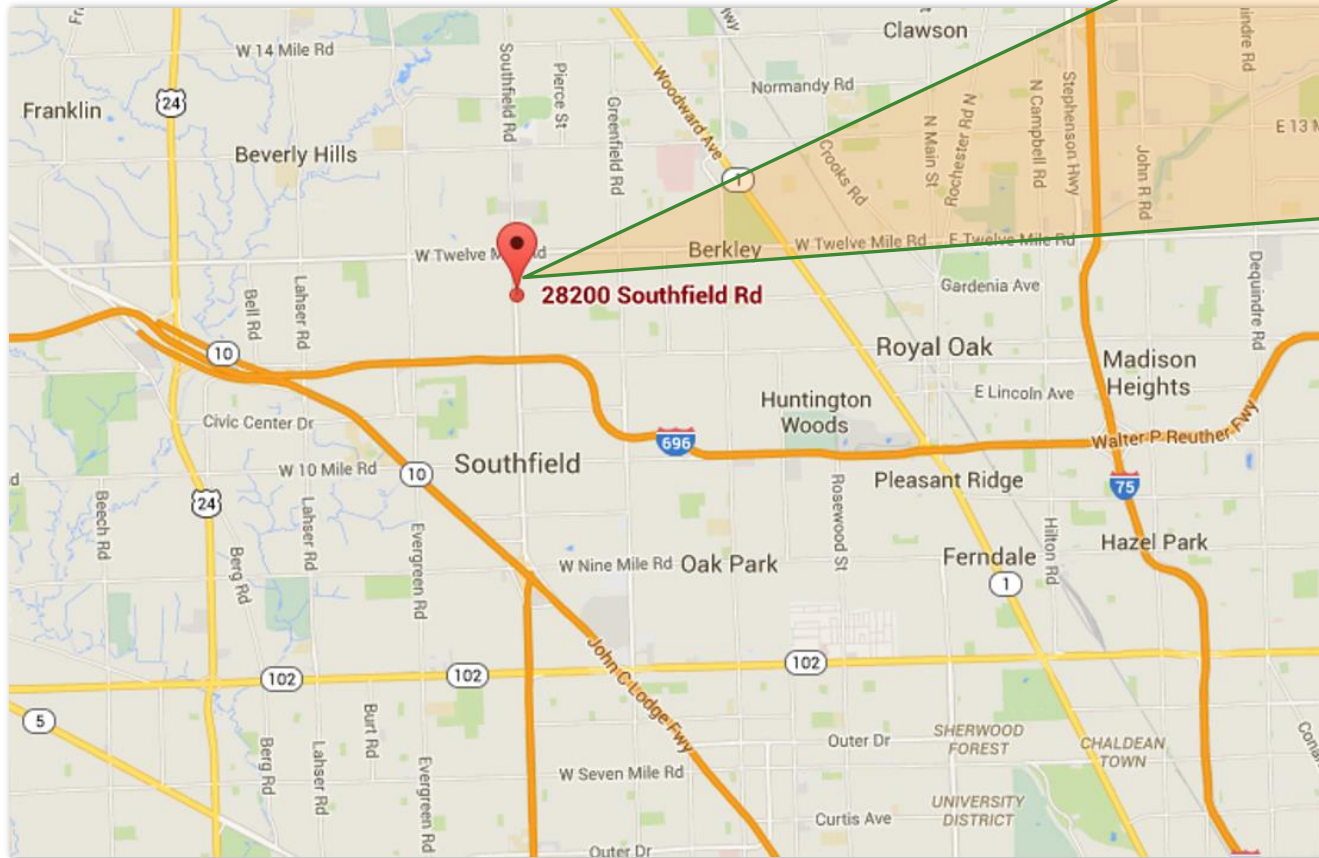

## Distance to:

- I-696 - .6 miles
- Southfield Freeway/M-10 – 2.6 miles
- I-75 – 6.6 miles
- I-96 – 11.8 miles
- Telegraph Road – 3.6 miles

# CURRENT STATUS

- 6.7k SF office building on .5 acre lot
- 100% occupied
- Sanitary sewer, gas, parking and water
- Privately owned – \$389,000 asking price
- Zoned MX – Mixed Use
- For more information, please call Josh Griffin with Griffin Properties at 248.443.9000

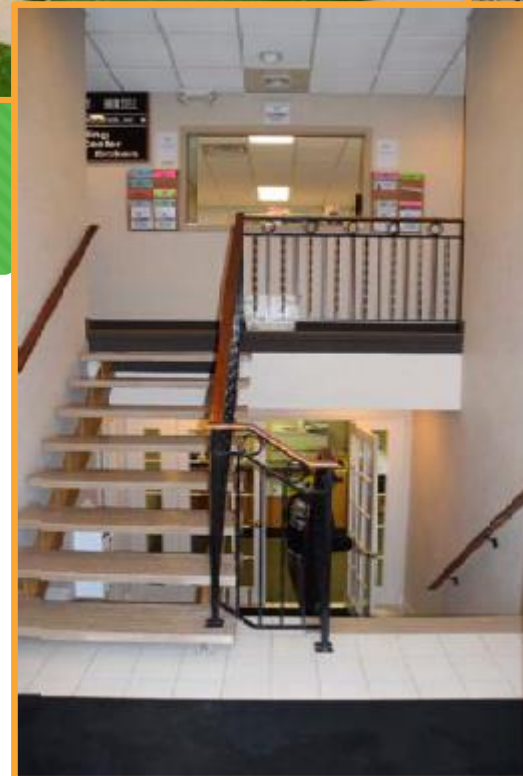

# WHY LATHRUP VILLAGE

- Adaptive reuse opportunity
- Demographics indicate that residents are:
  - Well-educated
  - Diverse
  - Upper-middle class
- Unique, historic housing stock creates unique location
- Lathrup Village and Oakland County both business friendly
- Residents eager to 'buy local' retail, as indicated by success of Famers Market and neighborhood restaurants
- DDA and City Administration dedicated to supporting future development

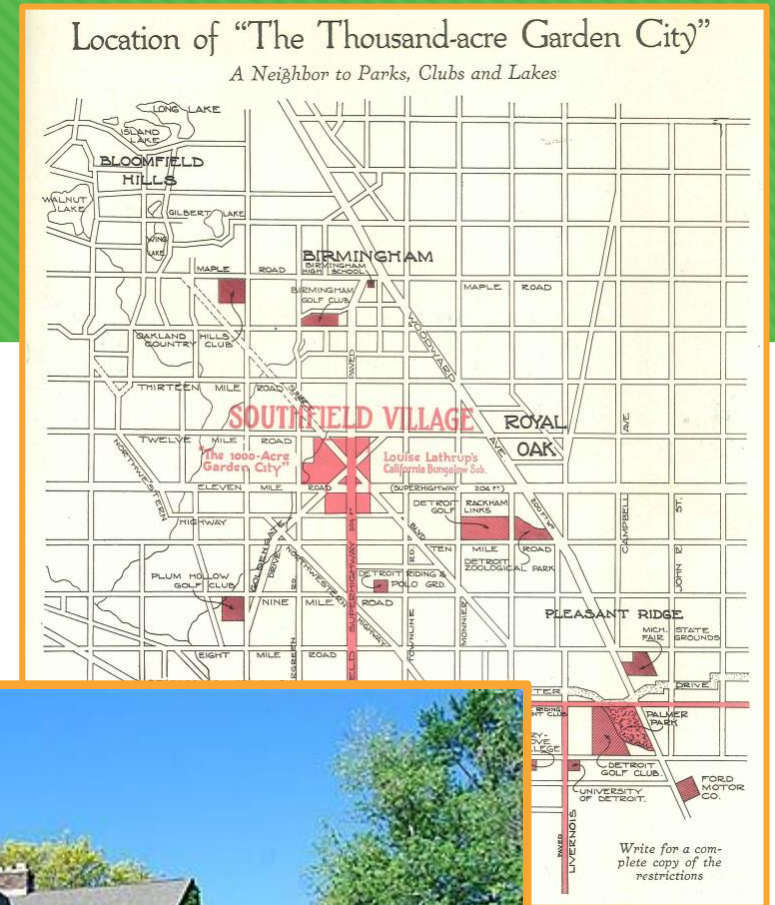

# POTENTIAL USES - CLASS A OFFICE SPACE

- 2013 Market Assessment and Strategy notes a supportable range of 14 - 130,000 SF of new office space
- Should focus on select professional and business service space
- Strong area for technology and medical economies
- Aging population indicates additional potential for outpatient medical and urgent care activity

